

# ELECTRIC Winch

## 900-1100-2200-3500-5000 kg

## CWG-30375, CWG-30565

## CWG-30750, CWG-31500

## CWG-34000

380V-440V x 3ph AC

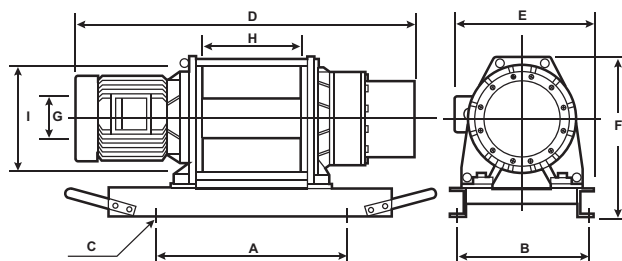

### FEATURES

- Heavy duty high efficiency ball bearings on all running surfaces
- Planetary gearing for maximum mechanical efficiency
- Cast steel foot mountings
- Fabricated steel drum
- Electromagnetic spring-applied failsafe brake
- Supplied on steel base plate ready to mount
- Rated capacity limiter limits driving power of the motor to prevent overloading of the winch
- Quiet running
- Emergency stop function switch is available upon request
- Low voltage control ass'y comes as standard

### DIMENSIONS mm

MODEL	Mounting bolt pattern			D	E	F	G	H	I
	A	B	C						
CWG-30375	500	370	4 - $\varnothing$ 19	974	400	445	127	230	275
CWG-30565	620	425	4 - $\varnothing$ 19	1,120	470	520	140	312	320
CWG-30750	600	499	4 - $\varnothing$ 22	1,246	565	658	178	312	410
CWG-31500	847	680	8 - $\varnothing$ 28	1,439	740	860	356	405	570
CWG-34000	920	680	8 - $\varnothing$ 32	1,860	740	905	324	680	570

### SPECIFICATIONS

MODEL	CWG-30375		CWG-30565		CWG-30750		CWG-31500		CWG-34000	
Option	A	B	A	B	A	B	A	B	A	B
Lifting capacity kg wire rope top layer	900		1,100		2,200		3,500		5,000	
Lifting speed, m/min	first layer	8.5	14	9.2	6.9	4.5	5.8	4.4	8	5.3
	top layer	13.5	25	16.4	12.6	8.3	8	6	12.2	8
Motor rating	Induction		Induction		Induction		Induction		Induction	
IP54	output, kw x poles	3.8 x 4 2.2 x 6	5.5 x 4 3.8 x 6	5.5 x 4 3.8 x 6	5.5 x 4 3.8 x 6	5.5 x 4 3.8 x 6	5.5 x 6 3.8 x 8	5.5 x 6 3.8 x 8	11 x 4 7.5 x 6	11 x 4 7.5 x 6
Gear ratio	48:1		50:1		127:1		192:1		197:1	
Maximum lifting height, m	58		97		97		144		192	
Braking methods	Electromagnetic		Electromagnetic		Electromagnetic		Electromagnetic		Electromagnetic	
Wire rope	size, mm x m	*10 x 60	*12 x 100	*12 x 100	*16 x 100	*16 x 100	*18 x 150	*18 x 150	*22.4 x 200	*22.4 x 200
	construction	6 x 24	6 x 24	6 x 24	6 x 24	6 x 24	6 x 24	6 x 24	6 x 24	6 x 24
	breaking strength, kg	4,640	6,680	6,680	11,900	11,900	15,000	15,000	23,300	23,300
Drum	length	230	312	312	312	312	405	405	680	680
dimension, mm	drum dia.	127	140	140	178	178	356	356	324	324
	flange dia.	275	320	320	410	410	570	570	570	570
Mounting bolts pattern (mm x mm)	500 x 370		620 x 425		600 x 499		847 x 680		920 x 680	
Standard accessory	Safety-latch hook	*	*	*	*	*	*	*	*	*
	Remote control	*	*	*	*	*	*	*	*	*
	Low voltage control	*	*	*	*	*	*	*	*	*
	Base plate	*	*	*	*	*	*	*	*	*
Net weight, kg (standard version)	185		250		400		800		1,380	
Gross weight, kg	225		285		445		870		1,545	
Body dimension, mm (L x D x H)	974 x 400 x 445		1,120 x 470 x 520		1,246 x 565 x 658		1,439 x 740 x 860		1,860 x 740 x 905	
Box dimension, mm (L x D x H)	1,140 x 590 x 620		1,290 x 650 x 680		1,390 x 710 x 830		1,590 x 840 x 1,020		2,040 x 840 x 1,100	

**Note :** 1. Above performance ratings are based on 50Hz supply.

(60Hz motor available as option resulting in a reduction of lifting capacities by 20% and a speed increase of 20%).

2. \*\*\* Means standard version